

PROYECTO ECOLOGICO TURISTICO  
 LOTIFICACION  
 SUP: 26,618.529 M2  
 69.975%  
 VIALIDAD  
 5,334.665 M2  
 14.025%  
 DONACION  
 SUPERFICIE 6,086.371M2  
 16.00%

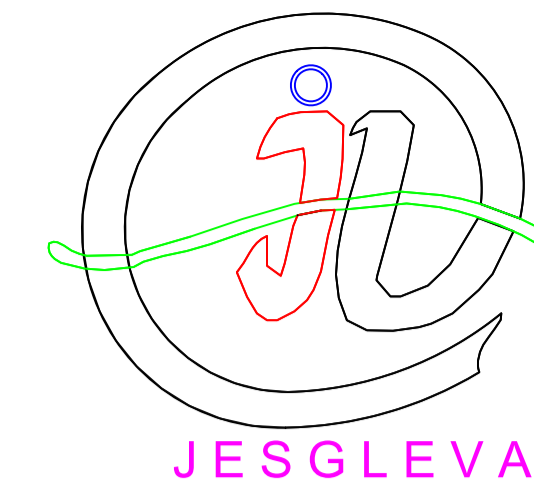

DIGITAL

CALLE IRENE ROBLEDO GARCIA 1260  
 GUADALAJARA, JALISCO, MEX.  
 TEL. 33-10-69-25-44

LEVANTO:  
 TEC. TOP. JOSE MARIA CUEVA PAZ  
 CED. 1435296  
 REG. No. 2 (20-10)

CALCULO:  
 TEC. TOP. JOSE MARIA CUEVA PAZ  
 DIBUJO:  
 MONICA RICO CAMACHO

DOMICILIO

PROPIETARIO :

UBICACION  
 LOCALIDAD: LA ESTANZUELA  
 MUNICIPIO: GUADALAJARA  
 ESTADO: JALISCO

CONTENIDO:  
 LEVANTAMIENTO TOPOGRAFICO

SELLOS

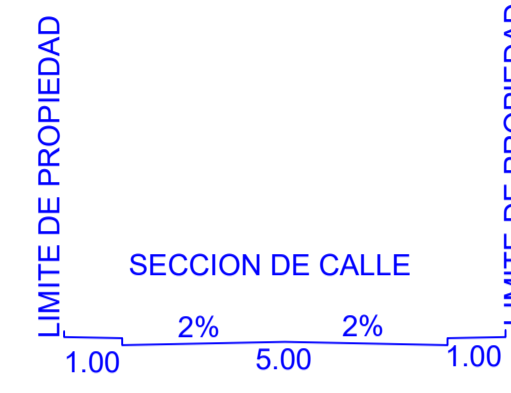
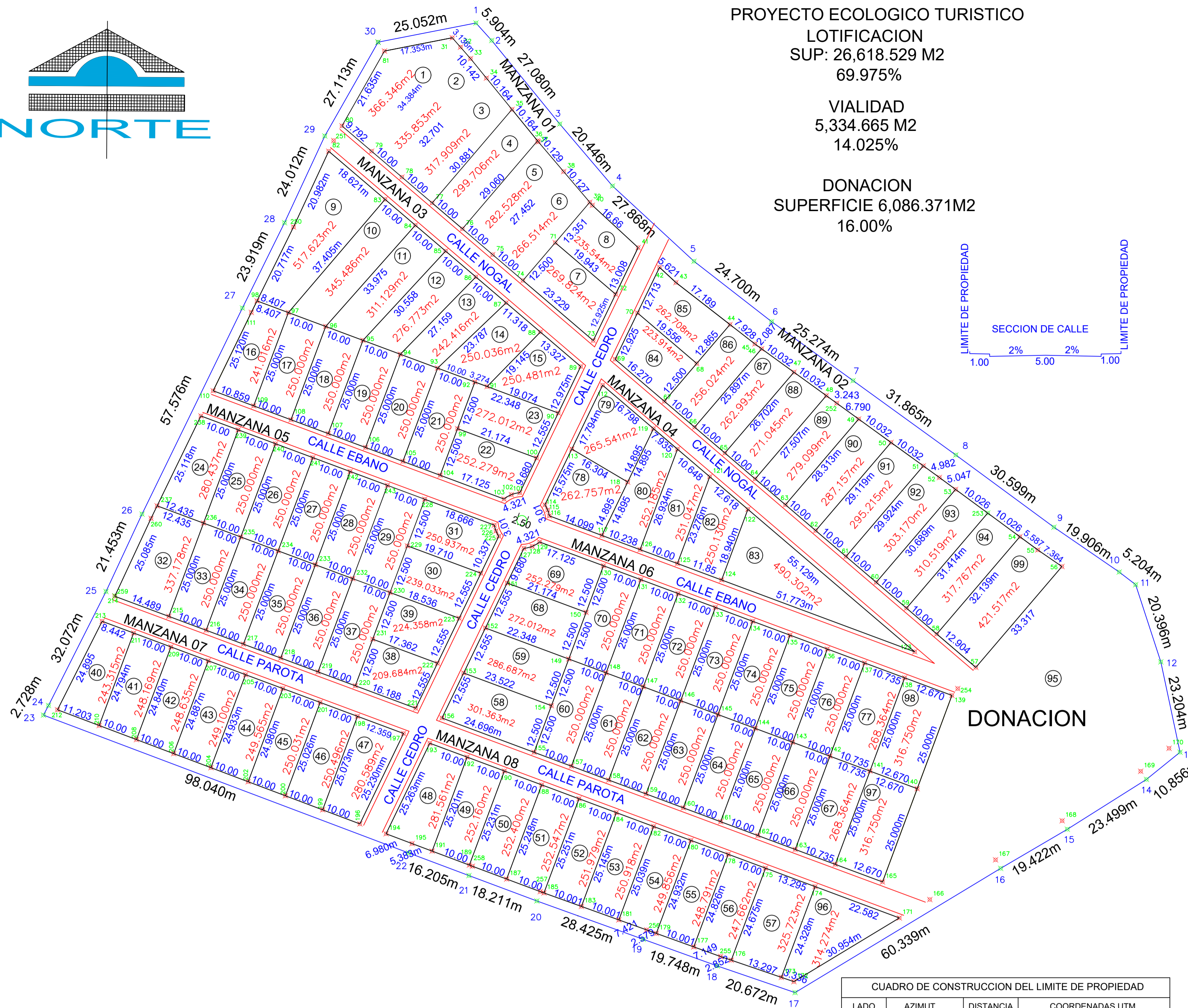

LOCALIZACION

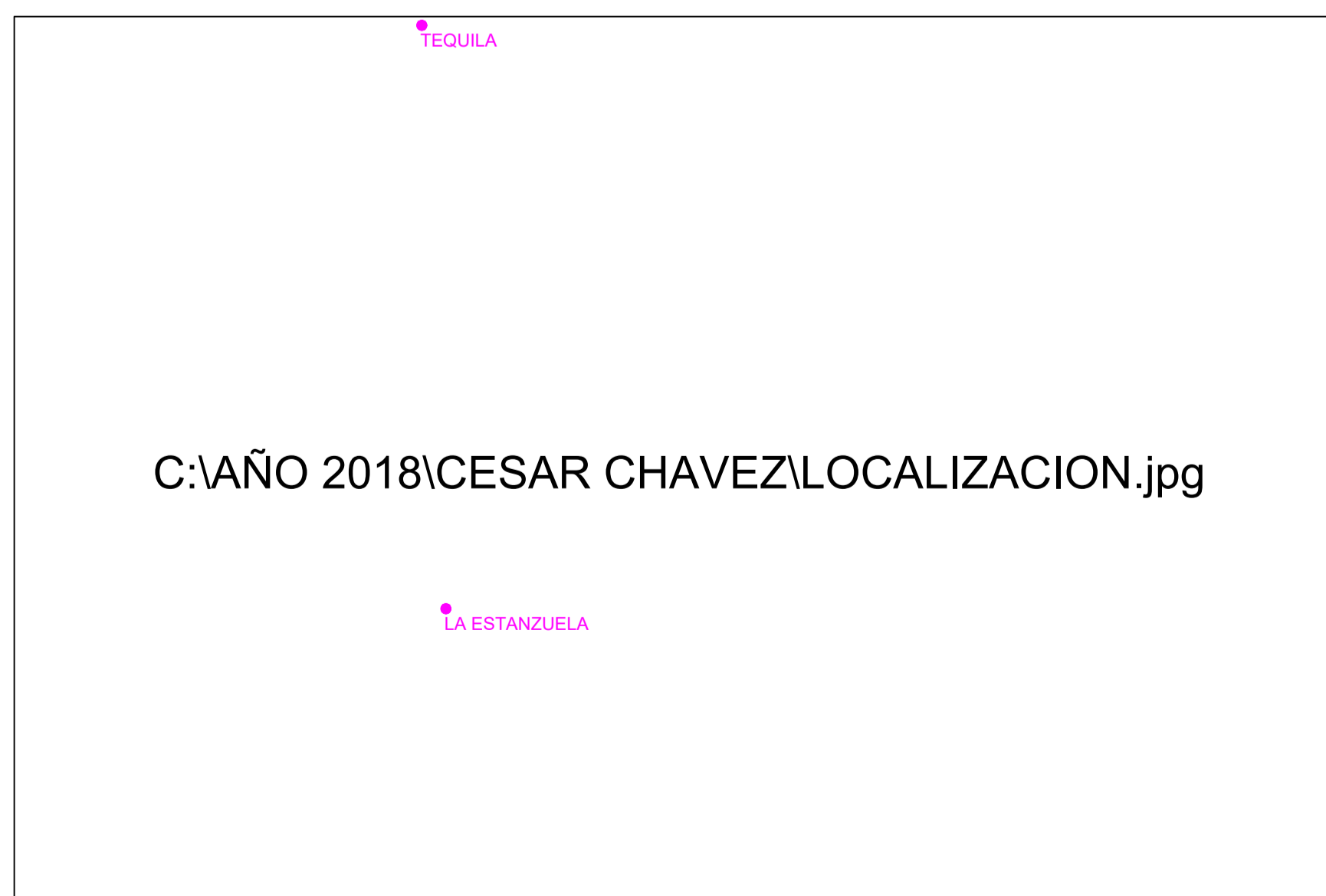

C:\AÑO 2018\CESAR CHAVEZ\LOCALIZACION.jpg

CUADRO DE CONSTRUCCION DEL LIMITE DE PROPIEDAD

| LADO EST-PV | AZIMUT        | DISTANCIA (MTS.) | COORDENADAS UTM ESTE (X) | COORDENADAS UTM NORTE (Y) |
|-------------|---------------|------------------|--------------------------|---------------------------|
| 1-2         | 138°02'14"    | 5.904            | 621,332.4222             | 2,285,732.4955            |
| 2-3         | 140°49'13"    | 27.080           | 621,336.3729             | 2,285,728.1077            |
| 3-4         | 139°35'58.13" | 20.446           | 621,353.4812             | 2,285,707.1169            |
| 4-5         | 132°44'11.41" | 27.868           | 621,366.7326             | 2,285,691.5469            |
| 5-6         | 127°52'12.40" | 24.700           | 621,387.2013             | 2,285,672.6347            |
| 6-7         | 125°53'54.03" | 25.274           | 621,406.6993             | 2,285,657.4723            |
| 7-8         | 125°53'41.99" | 31.865           | 621,427.1725             | 2,285,642.6531            |
| 8-9         | 126°21'21.50" | 30.599           | 621,452.9858             | 2,285,623.9708            |
| 9-10        | 124°28'16.13" | 19.906           | 621,477.6291             | 2,285,605.8314            |
| 10-11       | 127°32'32.34" | 5.204            | 621,494.0401             | 2,285,594.5646            |
| 11-12       | 161°56'16.83" | 20.396           | 621,498.1661             | 2,285,591.3937            |
| 12-13       | 167°59'29.93" | 23.204           | 621,504.4897             | 2,285,572.0033            |
| 13-14       | 231°0'30.45"  | 10.856           | 621,509.3174             | 2,285,549.3070            |
| 14-15       | 237°47'33.43" | 23.499           | 621,500.8796             | 2,285,542.4763            |
| 15-16       | 239°36'36.92" | 19.422           | 621,480.9968             | 2,285,529.9518            |
| 16-17       | 238°5'135.28" | 60.339           | 621,464.2437             | 2,285,520.1269            |
| 17-18       | 288°54'42.16" | 20.672           | 621,412.5989             | 2,285,488.9233            |
| 18-19       | 289°47'49.12" | 19.748           | 621,393.0425             | 2,285,495.6235            |
| 19-20       | 289°47'58.55" | 28.425           | 621,374.4614             | 2,285,502.3119            |
| 20-21       | 290°29'42.80" | 18.211           | 621,347.7167             | 2,285,511.9404            |
| 21-22       | 290°34'52.70" | 16.205           | 621,330.6581             | 2,285,518.3167            |
| 22-23       | 290°40'27.72" | 98.040           | 621,315.4871             | 2,285,524.0135            |
| 23-24       | 27°43'37.29"  | 2.728            | 621,223.7603             | 2,285,556.6273            |
| 24-25       | 26°46'34.16"  | 32.072           | 621,225.0297             | 2,285,561.0423            |
| 25-26       | 24°57'19.80"  | 21.453           | 621,239.4782             | 2,285,589.6750            |
| 26-27       | 25°58'14.78"  | 57.576           | 621,248.5295             | 2,285,609.1250            |
| 27-28       | 26°16'57.11"  | 23.919           | 621,273.7427             | 2,285,660.8867            |
| 28-29       | 24°55'1.60"   | 24.012           | 621,284.3338             | 2,285,682.3327            |
| 29-30       | 29°35'3.03"   | 27.113           | 621,294.4500             | 2,285,704.1093            |
| 30-1        | 78°56'10.39"  | 25.052           | 621,307.8360             | 2,285,727.6880            |

SUP = 38,039.697 M2 PERIMETRO = 791.788 m

FECHA:  
 JULIO 2020

ARCHIVO:  
 C:\2020\ CESAR CHAVEZ \ JULIO 2020 PROPUESTA 5 LOTES.DWG

